

# Ekka

ROYAL QUEENSLAND SHOW

Presented By:



## DANCE EISTEDDFOD SCHEDULE



# TABLE OF CONTENTS

<i>Competition Overview.....</i>	<i>3</i>
<i>Who Can Enter.....</i>	<i>4</i>
<i>Key Dates.....</i>	<i>5</i>
<i>Entry Requirements.....</i>	<i>5</i>
<i>Competition Structure.....</i>	<i>5</i>
<i>Entry Fees.....</i>	<i>5</i>
<i>Conditions of Entry.....</i>	<i>6</i>
<i>Video Submissions.....</i>	<i>6</i>
<i>Selection &amp; Finalists.....</i>	<i>6</i>
<i>Performance Conditions.....</i>	<i>6</i>
<i>Media &amp; Promotion.....</i>	<i>6</i>
<i>Stage Configuration.....</i>	<i>7</i>
<i>Judging Criteria.....</i>	<i>7</i>
<i>Contact Information .....</i>	<i>7</i>
<i>Costume Change Regulations:.....</i>	<i>8</i>
<i>Terms &amp; Conditions.....</i>	<i>9</i>



Photo credit: Theatre & Dance

## ENTRIES ARE NOW OPEN!

*Competition will be held at The Ekka Saturday 8<sup>th</sup> - Sunday 16<sup>th</sup> August 2026*

## COMPETITION OVERVIEW

### *The Ekka Dance Eisteddfod*

The Ekka Dance Eisteddfod provides an exciting performance opportunity for dance schools and studios to showcase their school's strongest performers dance routines as part of the Royal Queensland Show (Ekka).

The winning school will take home the inaugural Ekka Dance Eisteddfod 2026 Trophy and earn the exciting opportunity to perform live at Dreamworld, alongside a suite of additional prizes and exclusive experiences.

The competition celebrates entertainment, showmanship and performance impact, rather than age based or technical competition. Dance schools are invited to put their best foot forward, presenting routines that demonstrate energy, creativity and the ability to engage an audience.

**Dance schools submit one video entry showcasing their strongest routine as part of the pre-selection process (maximum four minutes; video compilations accepted). From these submissions, finalist schools will be selected to perform live at the Ekka, with each school receiving a 20-minute performance allocation (recommended as five individual routines of up to four minutes each).**



### ***Who Can Enter:***

Open to community dance schools and community performing arts studios

A maximum of 40 performers per dance school

Ekka entry passes will be provided for each participating student on the day of your performance, plus two passes per dance school for teachers. Additional tickets can be purchased via the Ekka website.

Prizes Include:

The Inaugural Ekka Dance Eisteddfod Champion Trophy (trophies awarded to 1st, 2<sup>nd</sup> and 3<sup>rd</sup> places)

- [Dreamworld](#) Performance Opportunity – The winning dance school will receive complimentary entry and the opportunity to perform live at Dreamworld.
- [Brisbane Powerhouse](#) Theatre Double Pass – Presented to the teacher of the winning school to award to their selected Star Student of the Day.
- Exclusive Masterclass – A private masterclass with renowned choreographer Nerida Matthaiei, [Phluxus Dance Collective](#).
- Exclusive Merchandise – Special prize merchandise provided by [Fresh Promotions](#).
- Professional Photoshoot Experience with [The Photo Studio](#) – Includes two exclusive photo sessions, awarded to the teacher of the winning school to present to their chosen Star Students of the Day.
- Complimentary Entry into [The Brisbane Performing Arts Challenge](#) (BMAC)– Winning school receives complimentary entry into the BMAC competition.

Conditions apply.



Photo credit: Universal Dance Company

## *Key Dates:*

- **Entries open from Wednesday 4<sup>th</sup> March [REGISTER HERE](#)**
- Video submissions close: 8pm Sunday 26 April 2026
- Finalist schools announced: Friday 1 May
- Live Performances: Saturday 8 - Sunday 16 August 2026
- Winner announced: Monday 17 August (winners will be notified via email)

## *Entry Requirements*

- Submit 1 x video showcasing your best dance routine via the [Exhibitor Portal](#)
- One entry per school
- Group routines only, solo entries are not accepted at the application stage. However, once selected as a finalist, each school may include one solo dance as part of their 20-minute showcase.
- Routine may include dancers of any age and experience
- Finalist schools will be notified by email on Monday 17 August

## *Competition Structure:*

### *First Round - Video Pre-Selection*

Dance schools submit one video entry showcasing their strongest routine. All submissions will be reviewed by a selection panel, with shortlisted entries invited to perform live at the Ekka.

### *Second Round - Live Ekka Showcase*

Selected finalist schools will be required to submit a \$10 application/admin fee. Each school will then be allocated a performance date and time between 8-16 August 2026.

Each school will have a 20-minute showcase slot, which can be made from multiple routines into one continuous mix, with one of these permitted to be a solo performance. Schools will perform live on an Ekka stage, competing for the inaugural Ekka Trophy, along with prizes for 1<sup>st</sup>, 2<sup>nd</sup> and 3<sup>rd</sup> place. Winners will be announced Monday 17 August (prizes can be collected from the RNA office or mailed out)

## *Entry Fees*

A finalist fee of \$10 will be payable by selected schools upon acceptance into the competition. Finalist fee deadline: 5pm Friday 22 May 2026



Photo credit: Universal Dance Company

## CONDITIONS OF ENTRY

### *Video Submission Conditions*

- Videos may be filmed in a studio or during a live performance.
- The full group and choreography must be clearly visible at all times.
- Heavy editing, visual effects or cuts that obscure performance are not permitted.

### *Selection & Finalist Conditions*

- All entries will be reviewed by the Ekka Entertainment Committee.
- A limited number of finalist schools will be selected due to programming constraints.
- Finalists will be notified in writing via email.
- Upon acceptance, finalist schools must pay a finalist participation fee by the specified deadline to confirm their place.
- Failure to confirm or pay the finalist fee may result in forfeiture of the finalist position.

### *Performance Conditions*

- Finalist schools will be allocated a 20-minute performance showcase at the Ekka.
- Performance dates and times will be confirmed closer to the event.
- Requests for preferred performance dates may be submitted but cannot be guaranteed.
- Schools are responsible for providing music in an mp3 format and adhering to allocated performance times.
- All performers must be dressed in non-branded, appropriate, family-friendly costumes suitable for a public, all-ages event, with footwear and attire appropriate for the Main Fashion Stage surface.

### *Media & Promotion*

By entering this competition, schools' consent to dancers being photographed and filmed for promotional, marketing and archival purposes by the Ekka and the Royal National Agricultural and Industrial Association of Queensland (RNA).

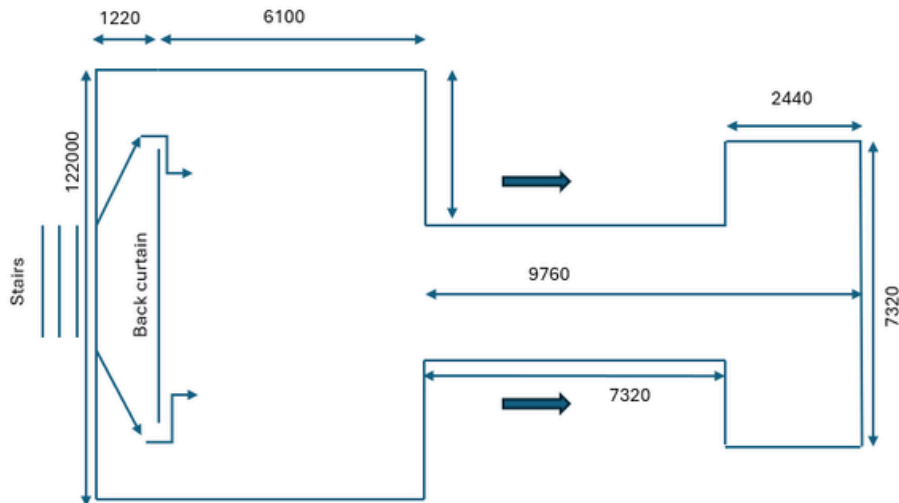

Photo credit: Universal Dance Company

Photo credit: Theatre & Dance

## Stage Configuration

The Ekka Dance Eisteddfod will be held on the Main Stage. Participants are encouraged to utilise all areas of the stage and adapt their choreography accordingly. Points will be awarded for showmanship and overall presentation, including costuming, stage presence and effective use of the performance space.



## Judging Criteria

Judging criteria will be based on:

Weighting (out of 100)	Criteria
30	Entertainment Factor
30	Showmanship & Stage Presence
20	Audience Engagement & Impact
20	Overall professionalism & Presentation

Judge's decision will be final. No correspondence will be entered into by the judging panel.

CONTACT INFORMATION:

[entertainment@royalqueenslandshow.com.au](mailto:entertainment@royalqueenslandshow.com.au)



Photo credit: Theatre & Dance

### *Costume Change Regulations:*

1. Performers must arrive dressed in their first costume and be performance-ready. Costume changes should only occur when required for subsequent routines.
2. Performers must be able to complete all costume changes independently within the dressing room. Parents, teachers, volunteers, and backstage helpers are not permitted in dressing rooms during the performance session.
3. The performance schedule will run as planned. Performers who are not ready at their allocated time may forfeit participation in that routine. All routines, entrances, exits, and costume changes must be completed within the allocated 20-minute continuous session, and music will not be paused to accommodate costume changes.
4. Costume changes must take place in the dressing room only. Hallways, wings, curtains, and side-stage areas cannot be used for changing.
5. No more than 20 performers may be in the dressing room at one time and be actively completing a costume change in the dressing room simultaneously. This limit ensures safe movement and appropriate use of the space.
6. Costumes should be designed for quick changes. Complex fastenings, significant hair restyling, and full makeup changes are not allowed. Only minor hair and makeup touch-ups are permitted backstage. Full restyling or makeup changes are not allowed during the session.
7. Performers must wear base garments, tights, or hosiery to minimise change time and support privacy in shared dressing spaces, in line with child safety guidelines.
8. No photography or filming is permitted in dressing rooms at any time.
9. Bags, costumes, and personal items must be kept tidy and clear of walkways and exits.
10. Event staff may step in if needed for safety, injury, costume issues, or performer wellbeing.
11. No additional entry passes will be issued for backstage assistance. Studios and performers must plan accordingly, ensuring all performers can manage changes independently within the provided space.

# GENERAL REGULATIONS

The attention of Exhibitors is drawn to the fact that all entries that are accepted will be subject to the Royal National Agricultural and Industrial Association of Queensland Act 1971, as well as to the By-Laws, General Regulations of the Association and any Competition Specific Regulations which appear in this schedule.

Judging will be performed by a panel of Judges appointed by the Royal National Agricultural and Industrial Association of Queensland.

No refunds will be made after close of entry. No refunds will be given for entries not presented or not adhering to the schedule regulations.

## NOTICE TO INTENDING EXHIBITORS

Entries for the Royal Queensland Show can ONLY be made online through our [Exhibitor Portal](#). Entries submitted other than on the online portal will be returned to the Exhibitor and, unless all requirements are submitted online by 5.00pm on the Application to Enter closing date, as shown in the Schedule, they will not be considered.

As a condition for acceptance of all entries, all exhibitors/competitors agree to the following:

- All information submitted as part of my exhibitor profile is true and correct, including taxation status and bank account information.
- Neither myself nor my family members will indulge in any social, professional or other interaction with an official or judge contracted or sub- contracted by the RNA before or during the Royal Queensland Show.

## PRIVACY STATEMENT

You can be assured that the privacy of your personal information is of the utmost importance to us. The information provided by you in any application for membership or application to enter is used by the Royal National Agricultural and Industrial Association of Queensland (RNA) to offer member services or to organize and conduct competitions at the Royal Queensland Show. By applying for membership or entering such competitions you consent to provide such details as your name, address and exhibit details. Competition information may be made available to the media and included in RNA publications.

The exhibitor irrevocably consents to the RNA publishing or reproducing in any manner whatsoever any particulars or information in relation to their exhibits; the publication or reproduction may be in a printed form or visual image through electronic means and/or on the internet. Your information will not be disclosed without your consent for any other purpose unless required by the law. By providing your email address you are consenting to receive communications from us relating to the Royal Queensland Show. For full privacy details visit <https://www.rna.org.au/privacy-policy.aspx>

## PRIZE MONEY

1. Prize Money stated in the Schedule excludes GST.
2. All Prizes and Prize Monies are SUBJECT TO CHANGE at the discretion of the Competition Committee
3. GST will be added to the Prize Money for Exhibitors who are registered for GST purposes.
4. Prize money will be paid into your nominated bank account by 31 October following the Show.
5. The Association will provide a "Recipient Created Tax Invoice" to Exhibitors who are registered for GST purposes
6. All cash prizes and trophies must be claimed within six months from the closing date of the Royal Queensland Show. Prizes not claimed and by that date will be considered to have lapsed, and the amount will become a donation to the Association. (RNA By-Laws)

## WORKPLACE HEALTH AND SAFETY

1. The Brisbane Showgrounds are a designated Workplace within the meaning of the Workplace Health and Safety Act 2011 and exhibitors/competitors are required to ensure that they and all persons under their direction or control, including their contractors or sub-contractors, comply with all requirements of the Act and the RNA holds each exhibitor responsible to discharge its obligations to provide and maintain a safe place and system of work during occupation by the exhibitor of any area of the Showgrounds.
2. Each exhibitor/competitor will assess the risk to themselves, staff, volunteers, family, other exhibitors, RNA staff, show visitors, children and any person foreseeably affected by the presentation of their exhibit.
3. Risks identified by exhibitors/competitors will be eliminated or controlled by the exhibitor/competitor and particular attention will be paid to ensuring public safety and safety of other exhibitors/competitors.
4. Exhibits will only be held and handled by competent persons whose experience is known to the exhibitor/competitor.
5. A "No Smoking Policy" will be strictly adhered to and policed by exhibitors/competitors and all are advised that the use of Primus stoves, any heating or lighting appliances of a like character, or any naked light, is strictly prohibited in the pavilions.
6. Any exhibitors/competitors intending to bring electrical equipment to the Showgrounds will be required to ensure that such equipment is fitted with residual current protection and that all electrical leads, tools and appliances have been inspected by a licensed electrical contractor and currently tagged. The use of double adaptors is prohibited, and all power boards must also be tested and tagged.
7. All exhibitors/competitors will comply with the requirements of the Act and its Regulations and Standards in every other respect. This is essential for the safety of all exhibitors/competitors and the general public. The Act imposes very severe penalties in the event of noncompliance with its provisions. Anyone who do not comply will not be allowed to exhibit at the Royal Queensland Show.
8. The Brisbane Showgrounds is subject to a Special Facility License issued under the Liquor Act 1992 and strict laws related to the consumption and possession of liquor across the Brisbane Showgrounds site. The consumption or possession of liquor outside of the licensed bar areas is not authorized by the RNA and in many cases may be an offence for which on the spot fines can be issued by Police and Liquor Licensing Investigators.

## DISCIPLINARY COMMITTEE

140. If there is any inconsistency between By-laws 141 - 162 and any other By-laws of the Association, By-laws 141 - 162 will prevail.
141. The functions of the Disciplinary Committee shall be to hear and determine all complaints, allegations and other matters relating to:
- prohibited substances, as defined in these By-laws or Sectional Regulations.
  - any alleged breach of the Rules, By-Laws and Regulations of the Association by an exhibitor and relating to an exhibit or to a competition, except if the alleged breach is of a kind that the Chairman of a Sectional Committee considers is of a less serious nature and should properly be dealt with by the Sectional Committee, and
  - any other alleged breach of the Rules, By-Laws and Regulations of the Association that may be referred to Disciplinary Committee pursuant to By-Law 145.
155. The Disciplinary Committee may announce its decision orally or in writing. A decision that is announced orally shall have effect in accordance with its terms.
156. If the opinion of the Disciplinary Committee is not unanimous, the decision of the majority shall prevail. If the Disciplinary Committee are equally divided on any question concerning the guilt or innocence of a person, the question shall be resolved in that person's favour.
157. If the Disciplinary Committee considers that there has been a breach of the rules, By-laws or regulations of the Association, it may impose such a penalty as it considers to be appropriate, including without limitation:
- a reprimand.
  - a monetary fine (payable at such time/s as the Disciplinary Committee may determine)
  - withdrawal or withholding of any award or ribbon.
  - disqualification in respect of any class.
  - expulsion from the Showground.
  - where the person concerned is a member, a suspension or termination of that membership.
  - a ban.
  - exclusion.
  - prohibiting a Person from exhibiting or competing at the current Show or at any future Show.
  - a direction that an Exhibit be removed from the Showground.
  - any other mandatory requirement; and
  - any other penalty provided for in other regulations of the Association.
158. There shall be no appeal from any decision of the Disciplinary Committee.

## INSURANCE

170. The RNA may (but is not obliged to) take out a policy of insurance in respect of the legal liability on the part of an Exhibitor for loss or damage suffered by a third party caused by any act or omission of an Exhibit or the Exhibitor.
171. The RNA, RNA Staff Members and Officials of the RNA are not liable to any Exhibitor if the RNA fails to take out a policy of insurance effectively protecting any Exhibitor or Exhibit, or if any such policy does not operate to indemnify the Exhibitor in respect of the loss or damage in question.

## REGULATIONS & BY-LAWS

All Entries and Exhibitors are subject to RNA Regulations and By-Laws set out in this schedule as well as other By-Laws that may pertain to this competition.

The RNA always reserves the right at its absolute discretion without assigning any reason to:

- substitute a Judge when necessary.
- re-allocate Judging days for a particular breed.
- if entries numbers require an extra Judge, appoint an additional Judge if necessary.

Full copies of the RNA By-Laws may be obtained upon application to the Competitions Department.

If you are unsure of any of the rules stated in this schedule or your eligibility to enter the competition, please contact the entries department at [entries@royalqueenslandshow.com.au](mailto:entries@royalqueenslandshow.com.au)

## GOODS AND SERVICES TAX

The RNA's ABN is 41 417 513 726

# Ekka

ROYAL QUEENSLAND SHOW

Presented By:



# ENTERTAINMENT

